

EN BUMPER KIT INSTALLATION MANUAL

DE MONTAGEEINLEITUNG FÜR STOBFÄNGER-KIT

RU ИНСТРУКЦИЯ ПО УСТАНОВКЕ ПЕРЕДНЕГО БАМПЕРА



For: Stels Витязь SA800 (2019-)

2444.6751.1;
444.6751.1



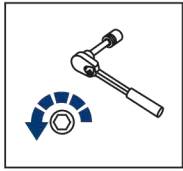

EN Regular fasteners
DE Originale montageile
RU Штатный крепеж

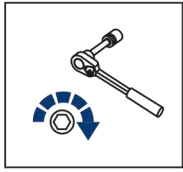

EN Regular fasteners
DE Originale montageile
RU Штатный крепеж

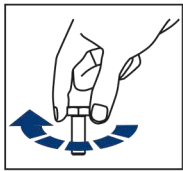

EN Screw a several turns
DE Für wenigen Umdrehungen befestigen
RU Вкрутить на несколько оборотов

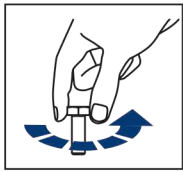

EN Loosen bolts
DE Bolzen lockern
RU Выкрутить на несколько оборотов

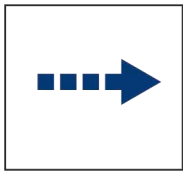

EN Movement Arrow
DE Bewegungsrichtung
RU Движение

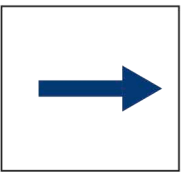





EN Location/Position Arrow
DE Anordnung/Positionsrichtung
RU Расположение

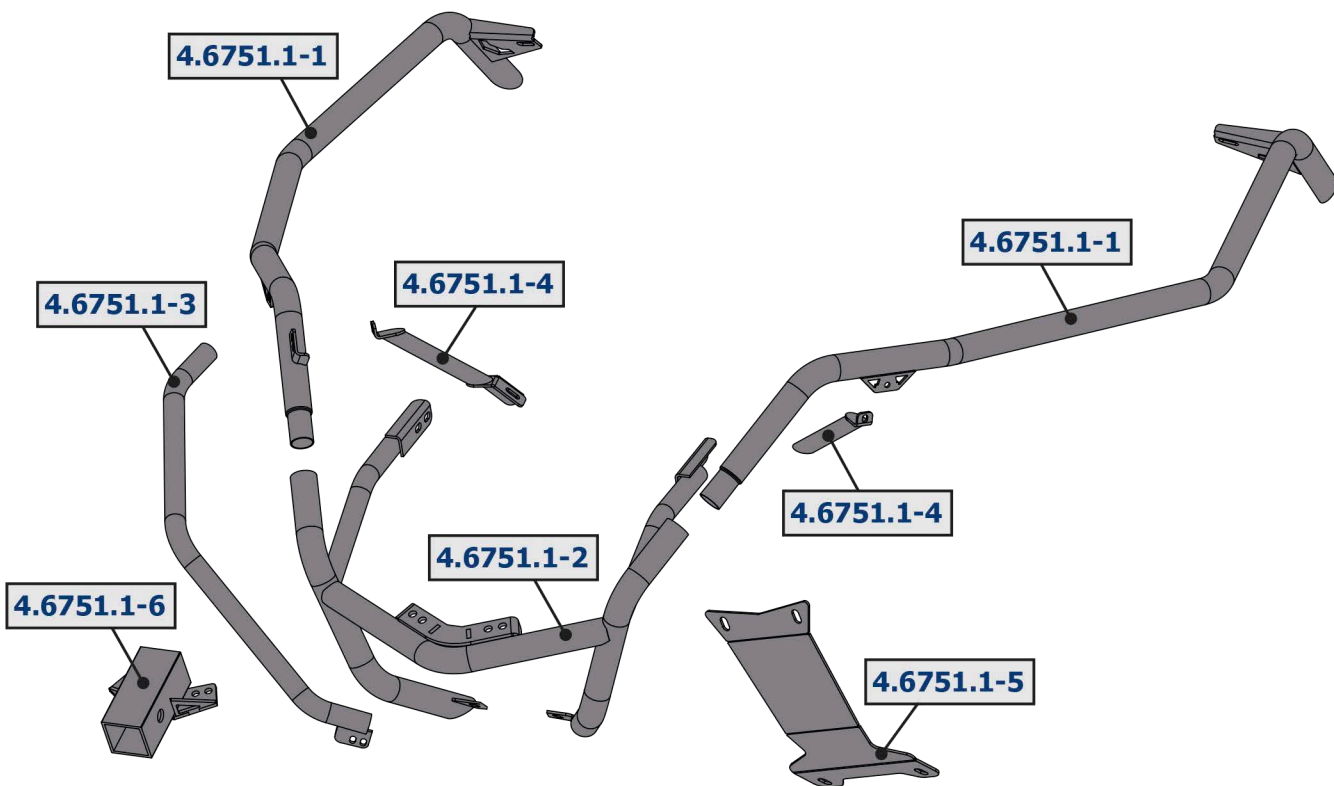
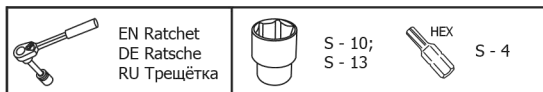

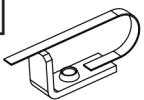
EN Screw Arrow
DE Drehungsrichtung
RU Поворот

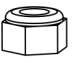

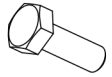
1  x2	2  M6x20 x8	3  ø6 x16	4  M6 x18	5  M8x20 x2	6  ø8 x4
7  M8x25 x4					

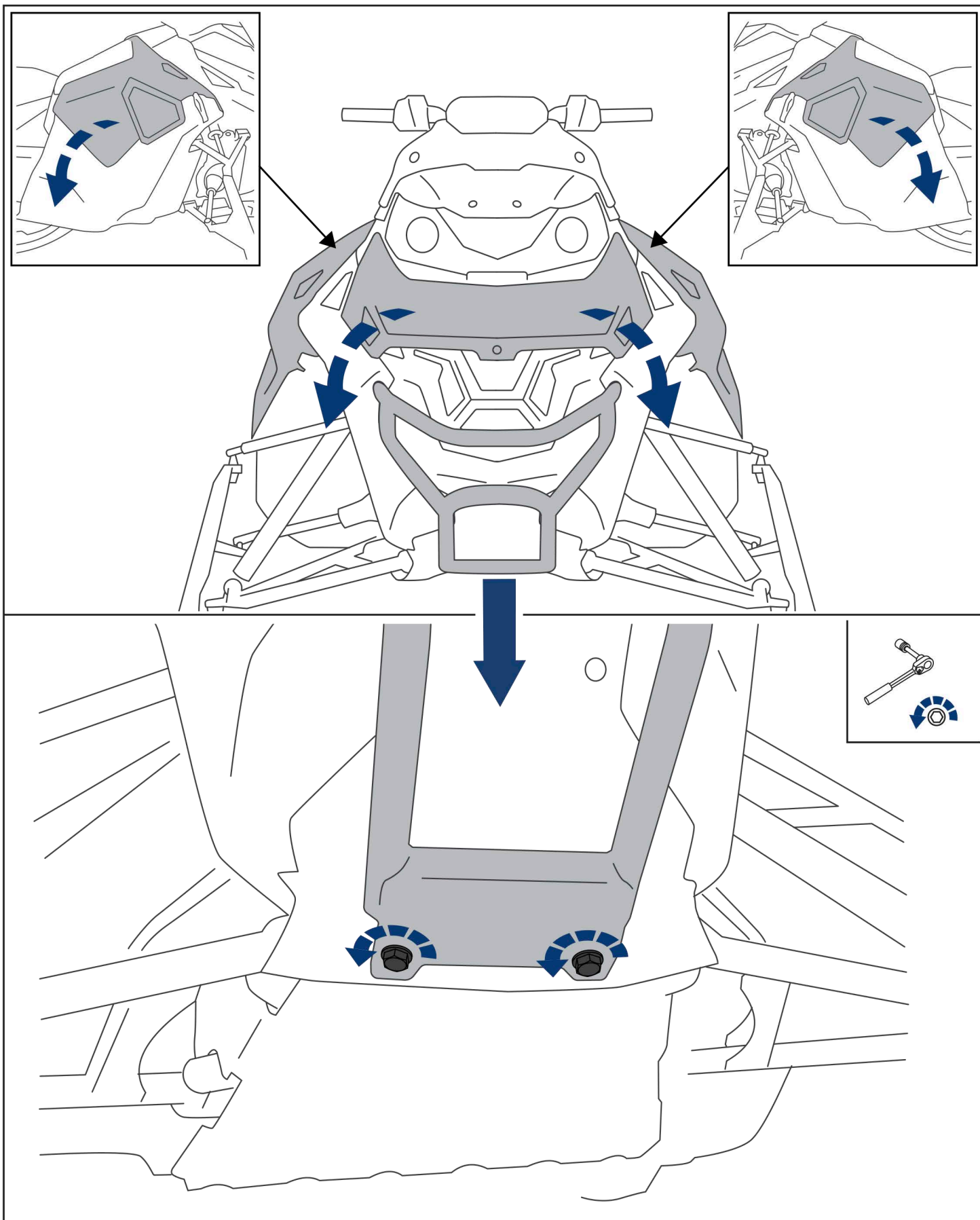

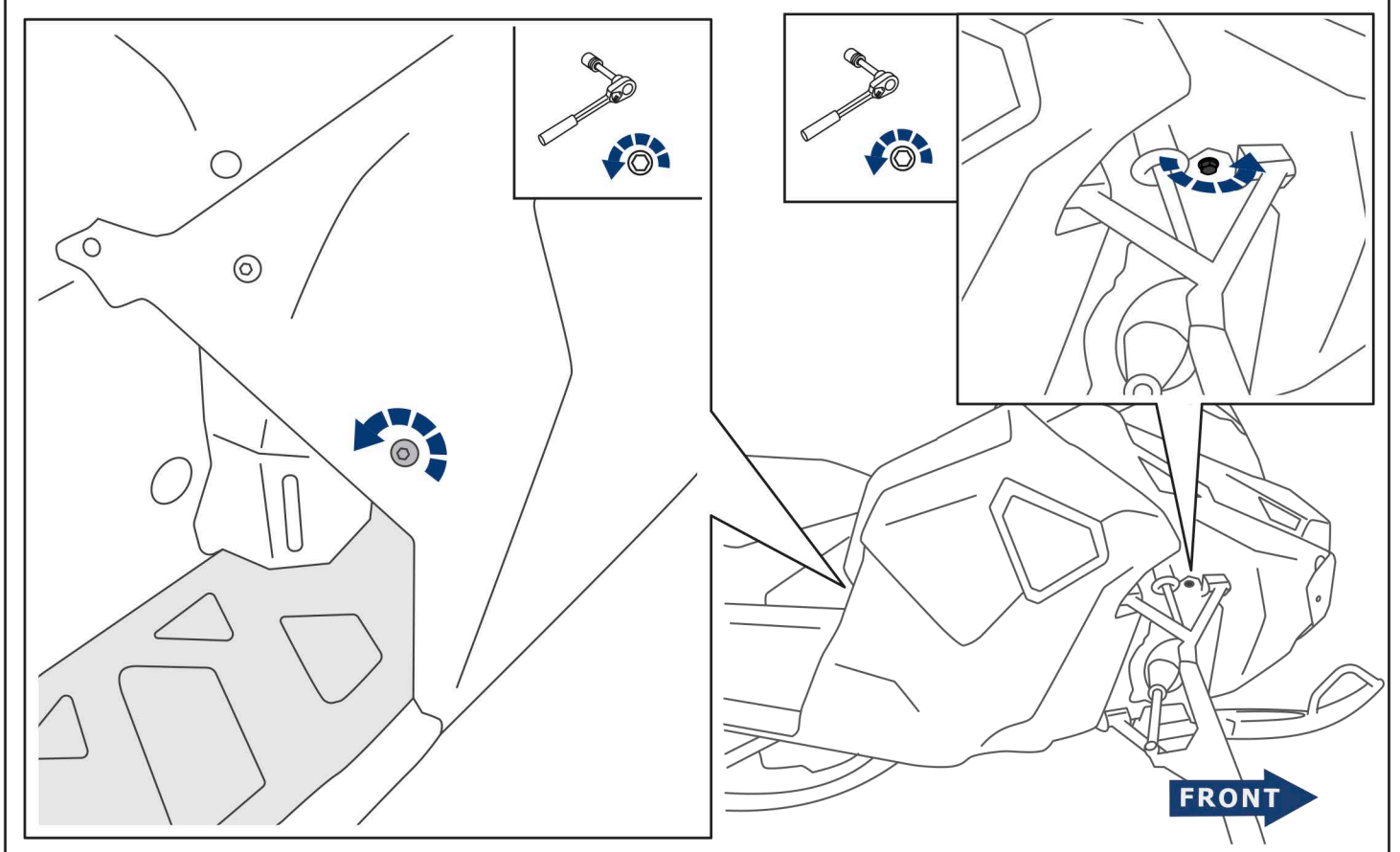
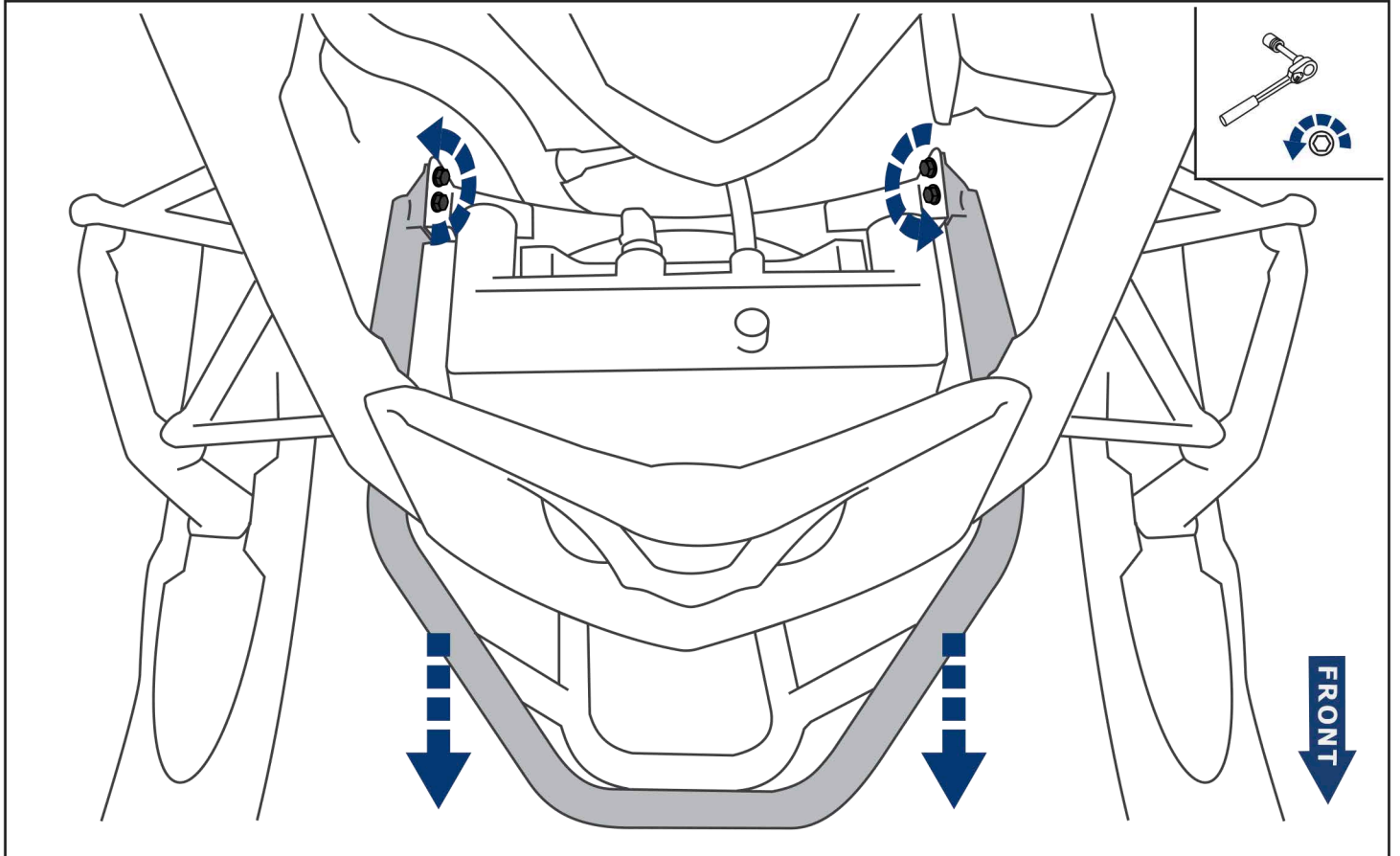

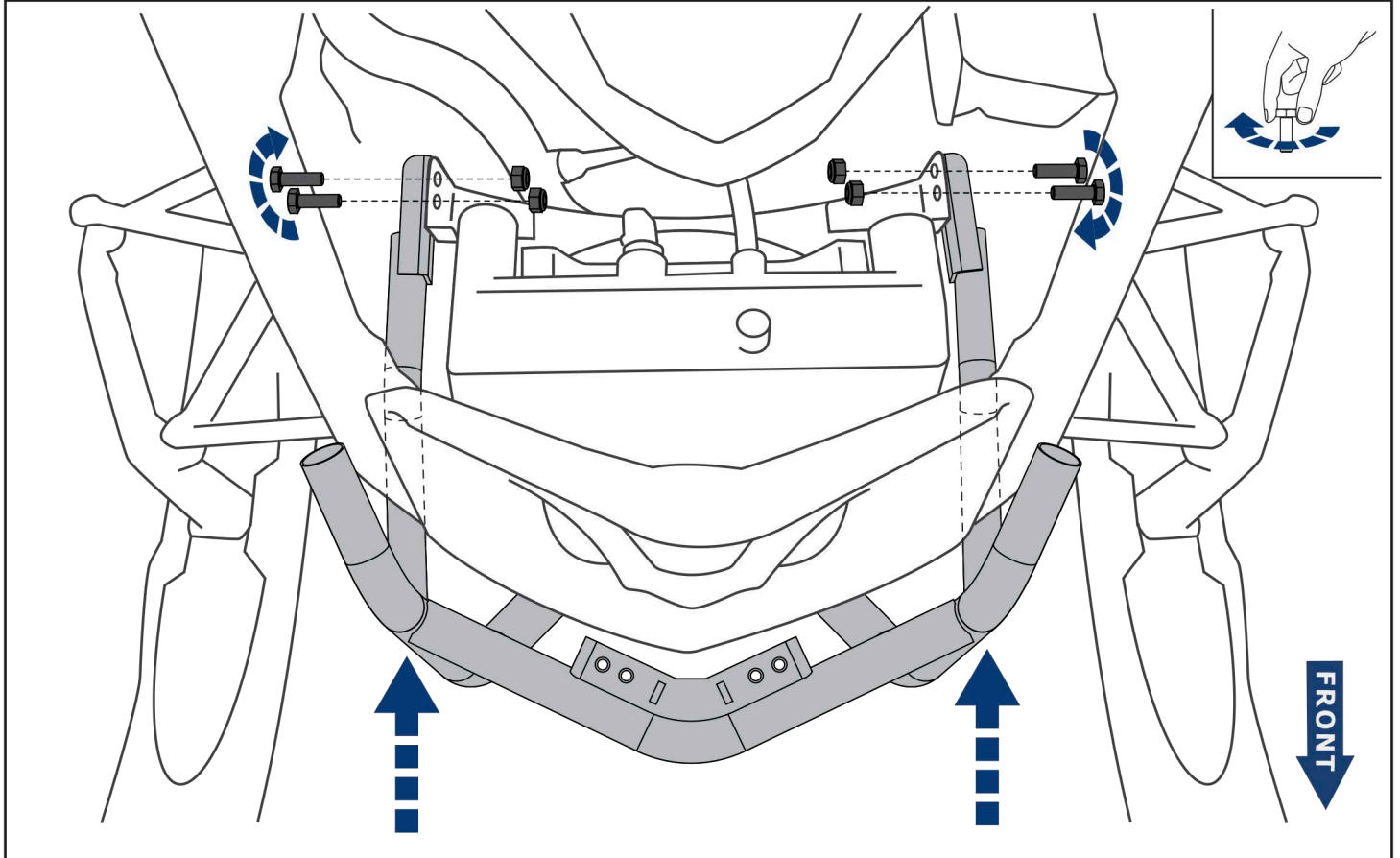
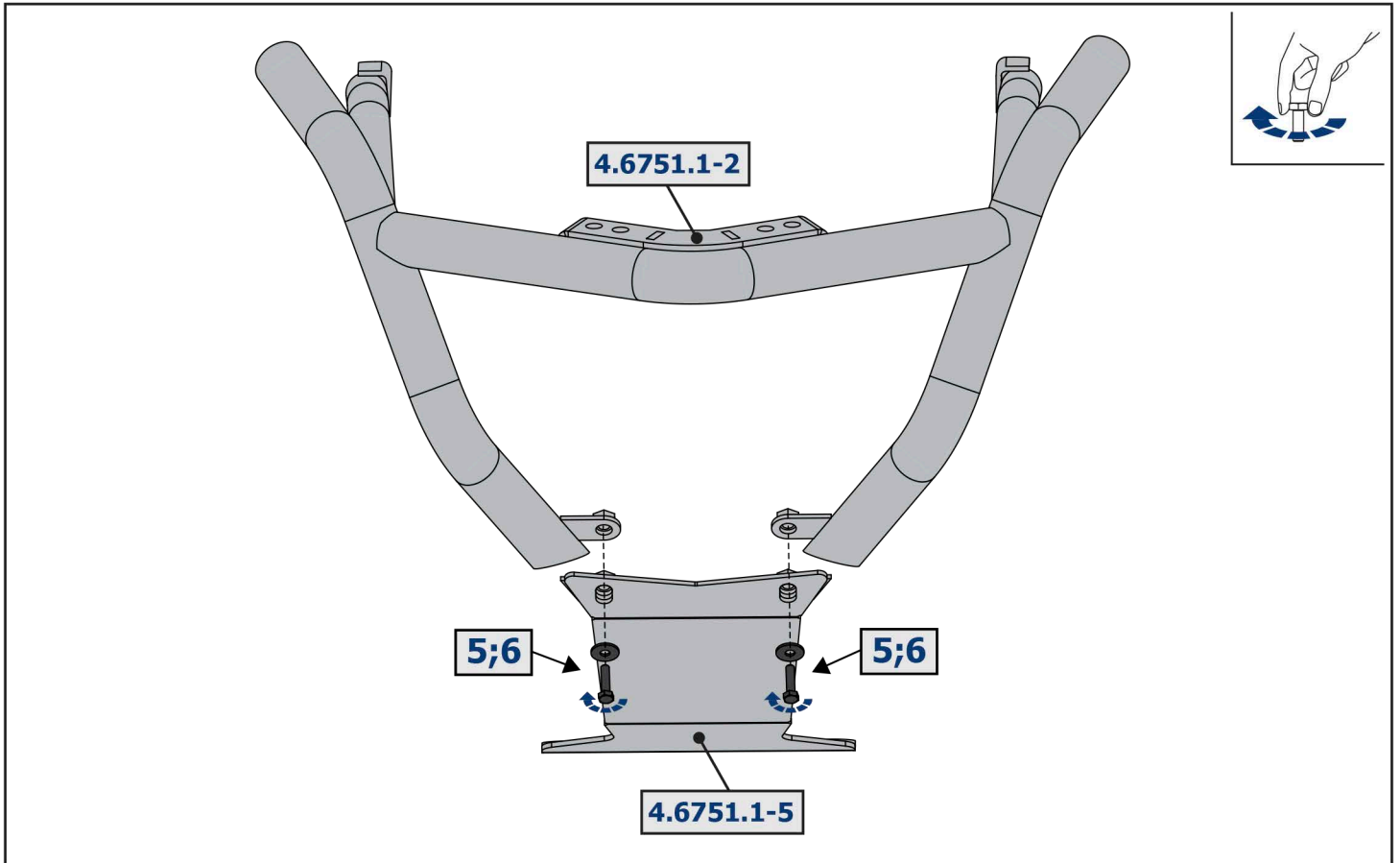

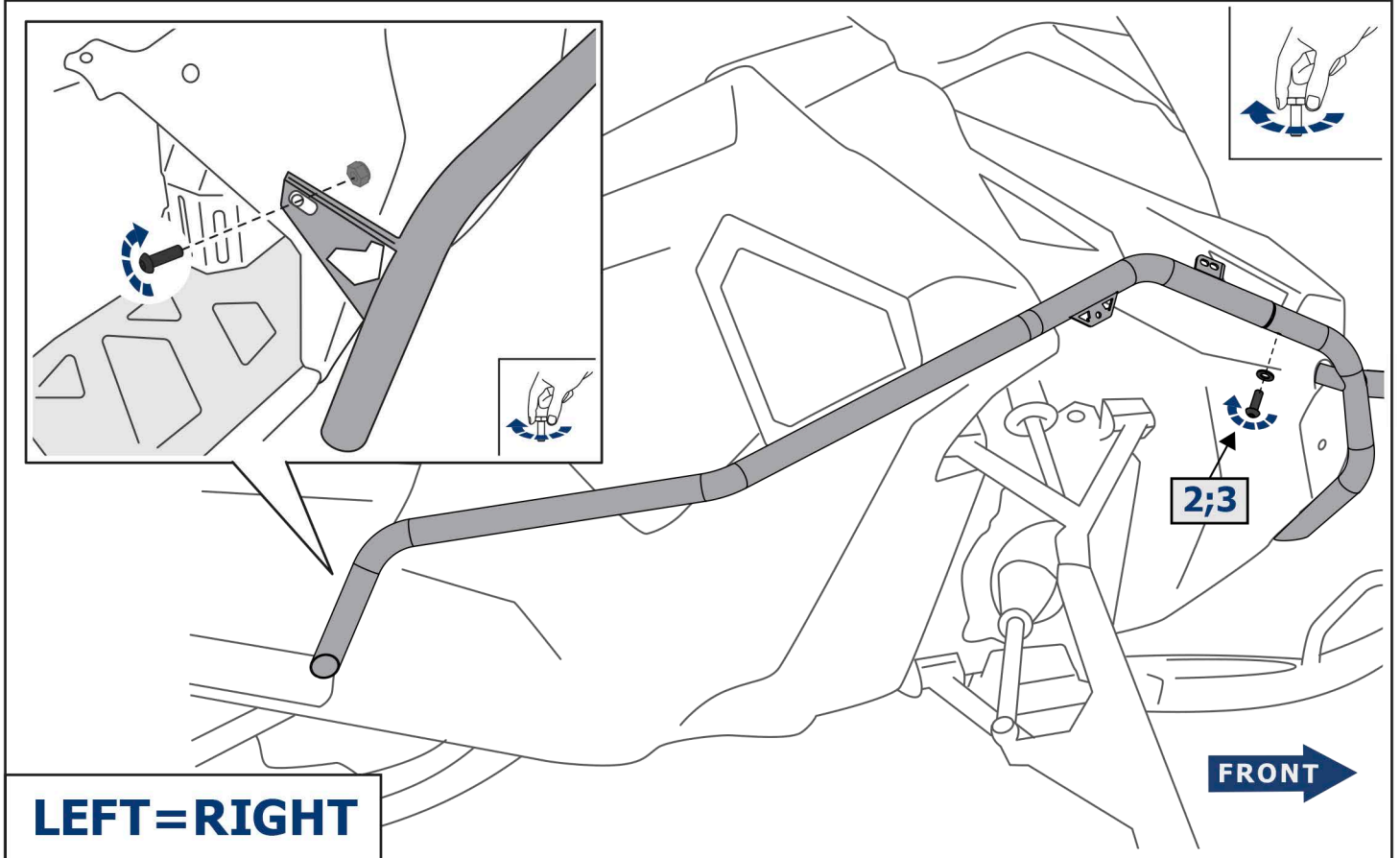
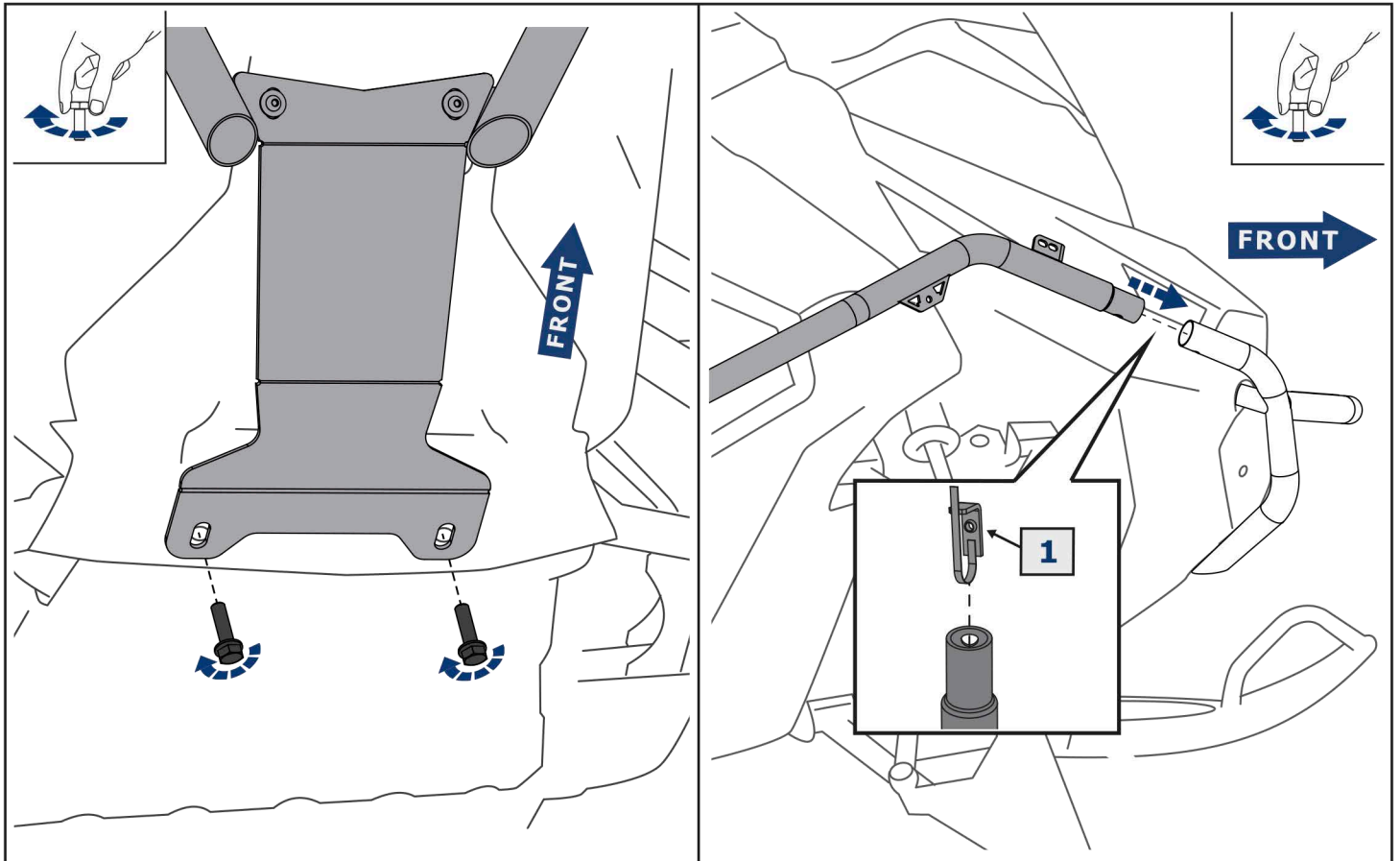

LEFT=RIGHT

